

**NOTE: DO NOT DISCARD the Parts List from the Instruction Bulletin. Place the Parts List in the appropriate place in the machine manual for future reference. Retaining the Parts List will make it easier to reorder individual parts and will save the cost of ordering an entire kit.**

*NOTE: Numbers in parenthesis ( ) are reference numbers for parts listed in Bill of Materials.*

Installation instructions for **kit number 9003789**

## SYNOPSIS:

This kit contains the parts needed to install/replace the filter tray on M20 machines (serial numbers 0000-2141).  
Please follow step-by-step instructions.

## SPECIAL TOOLS / CONSIDERATIONS: NONE

(Estimated time to complete: 20 minutes)

## PREPARATION:

1. Park the machine on a clean level surface and set the parking brake.
2. Raise the hopper to the middle support position and engage the hopper support pin. Refer to Operators Manual for instructions and safety information. Refer to Fig. 1.



**WARNING: Raised hopper may fall. Engage hopper support pin.**



**WARNING: Lift arm pinch point. Stay clear of hopper lift arms.**

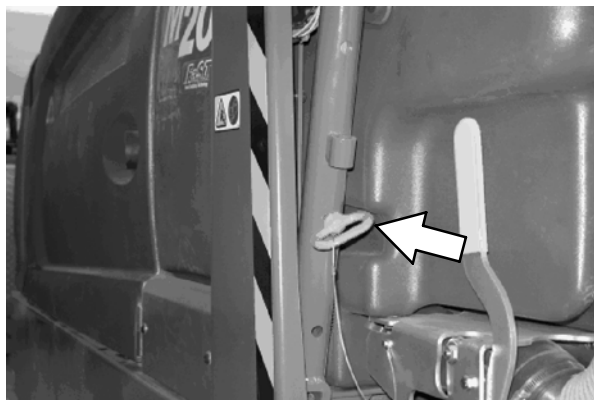

FIG. 1

3. Turn off the machine and remove the key.

**FOR SAFETY: Before leaving or servicing machine, stop on level surface, set parking brake, turn off machine, and remove key.**

4. Disconnect all hoses and cables from the hopper filter cover and remove the cover and the filter from the hopper. Set the filter and cover aside. Refer to the Operators Manual for instructions.

## INSTALLATION:

1. **For machines equipped with metal perma-filter tray only (proceed to Step 2 if machine is not equipped with a metal perma-filter tray):** Remove the existing perma-filter tray from the hopper. Discard the tray and all hardware. Refer to Fig. 3.
2. Place the new perma-filter tray into the hopper. Refer to Fig. 2.

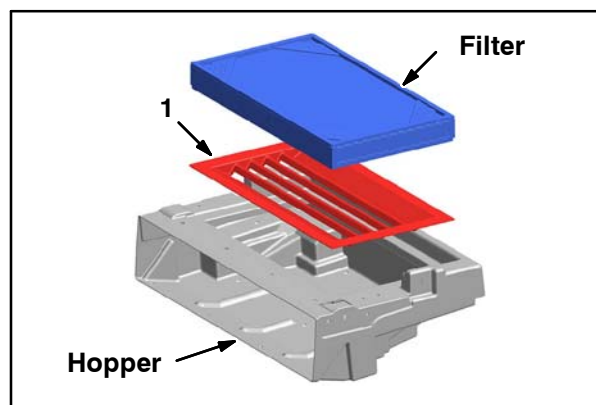
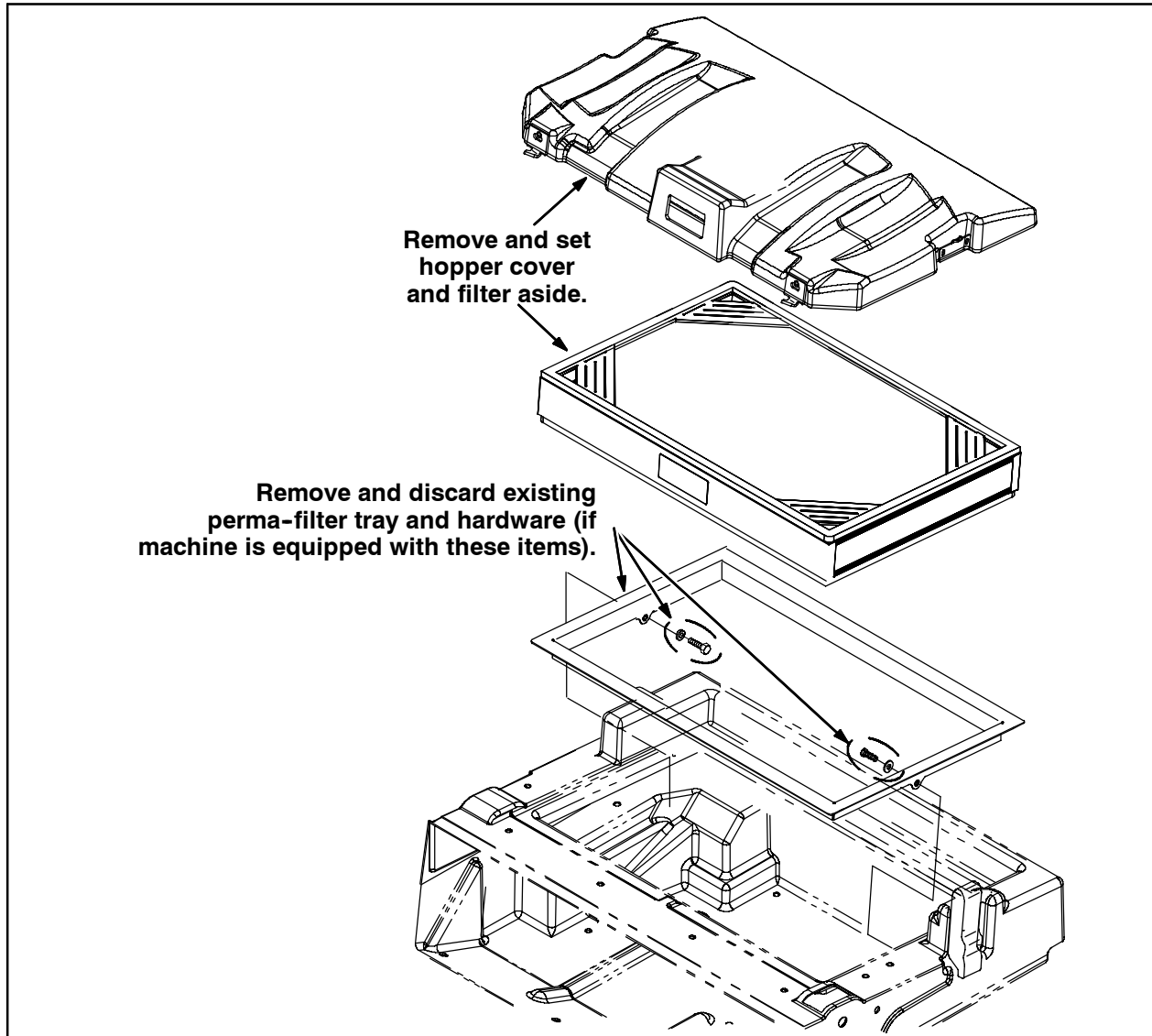

FIG. 2

*NOTE: No seal is needed for the new perma-filter tray (1). The perma-filter tray provides adequate vacuum seal for the hopper.*

3. Reinstall the filter into the hopper. Refer to Fig. 2 and Fig. 3.
4. Reinstall the hopper cover onto the hopper. Reattach all cables and hoses to the hopper cover. Refer to the Operators Manual for instructions. Refer to Fig. 3.
5. Start the machine, lower the hopper, and test the machine.



**FIG. 3**

**Bill of Materials for Hopper Kit, Modif, Screen, Filter-9003789**

Ref.	Tennant Part No.	Description	Qty.
▽	9003789	Hopper Kit, Modif, Screen, Filter	1
▲	1 1037947	Tray, Perma-Filter	1

TENNANT COMPANY  
P. O. Box 1452  
Minneapolis, MN 55440-1452